

# CS-1501/CS-1502 100W/150W Phased Array Column Speaker



**Product ID:** CS-1501/CS-1502

## **Short Description**

Rated power: 100W/150W

Acoustic configurable beam

LED screen display

## **Description**

This active column speaker build-in digital amplifier and digital signal processor, allow users adjusting the vertical beam radiation directivity through remote controller, to make it adapt to the different requirements according to the building acoustics. It is being great use specially in places with reverberation and complex acoustics (Churches, Sport centers, Halls, etc. ).

Build-in digital signal processor, like the inside equalizer, can obviously improve the sound quality compared to the conventional columns. Inside amplifier consists of 10 digital D-class channels and provides a high efficiency.

The system can automatically cut off its power and leave it in standby when there is no audio signal input (energy savings). Remote control function makes all adjustment easy and comfortable.

- ? Rated power: CS-1501/CS-1502: 100W/150W
- ? Acoustic configurable beam
- ? Loud beam inclination upto  $-45^{\circ}$  to  $+45^{\circ}$
- ? SPL variation between -3dB to +3dB in the covered area
- ? Audio signal input: 0dB (300mV) or 70~100V
- ? Input sensitivity adjustable
- ? Equalizer adjustment
- ? Volume control, treble and basee adjustment separately
- ? LED screen display volume (base/treble), input sensitivity, equalization, directional angle, focus point, etc.
- ? Mute function
- ? All functions remote control availabl

### Connection Ports Description

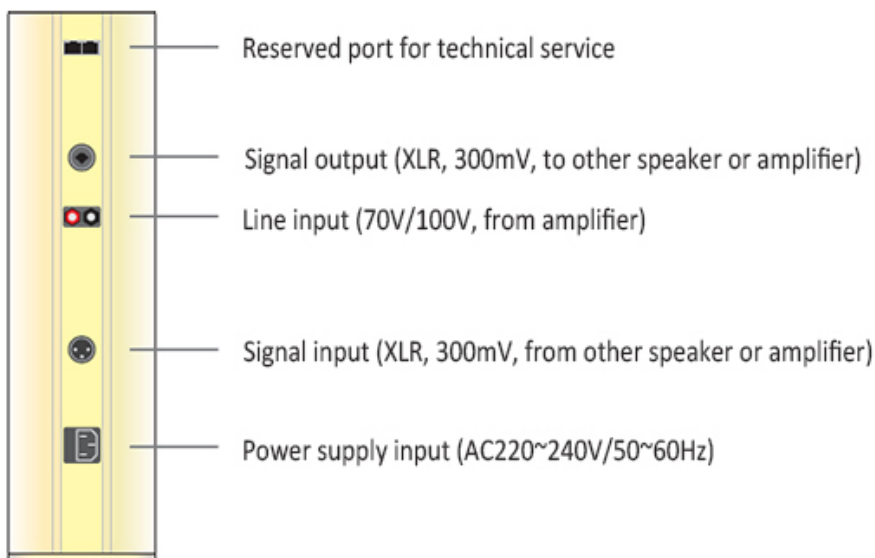

### Connection Drawing (70V/100V)

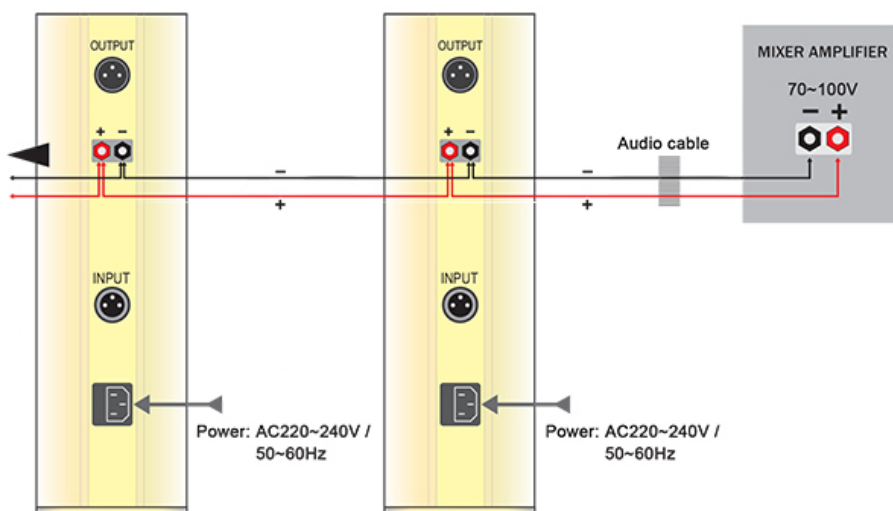

### Connection Drawing (AUX via XLR port)

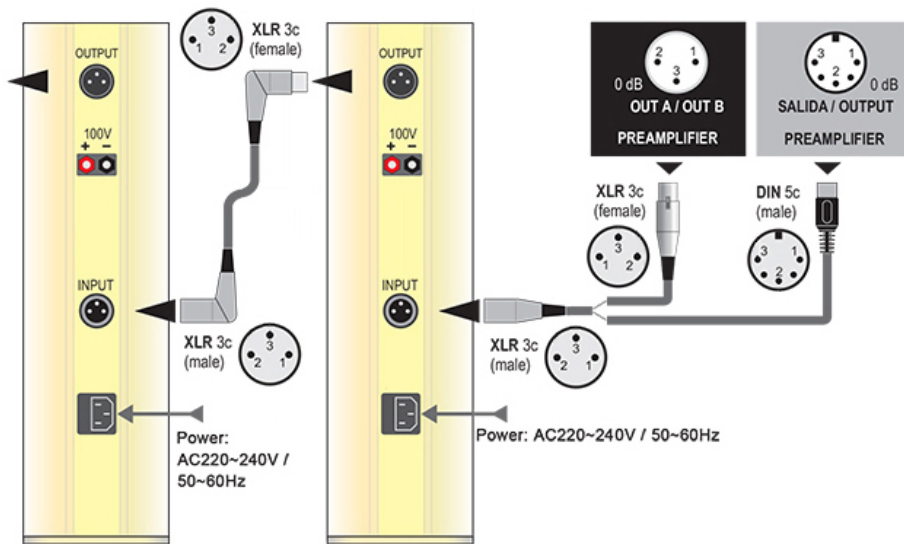

## Specification

Model No.	CS-1501	CS-1502
Rated power	100W	150W
Effective frequency range	80Hz-18KHz	
Lobe inclination adjustment range (vertical)	-60° ~ +60°	
Lobe inclination adjustment range (horizontal)	-45° ~ +45°	
Lobe focus radiation range	-5m ~ -200m; +5m ~ +200m	
Frequency response	80Hz - 18KHz	
Sensitivity	98dB (1m, 1W)	
Max sound pressure level	188dB	
Sensitivity adjustment	00dB, -06dB, -10dB at 100V input	
Input sensitivity (Line)	300mV (-10dB) / 500mV (-6dB) / 1000mV (00dB)	
Input sensitivity (70-100V)	30V (-10dB) / 50V (-6dB) / 100V (00dB)	
Equalizer points (14 points)	80/120/270/420/640/1K/1.5K/2.2K/3.3K/5K/7.5K/12K/18K/20K Hz	
Equalizer adjustment range	±12dB	
Power supply	AC220~240V / 50~60Hz	
Speaker driver size	4" x 10pcs	5" x 10pcs
Net weight (Kg)	13	22
Packing weight (Kg)	16	26
Product dimension (mm)	1365*146*132.3	1602*153*154.5
Packing size (mm)	1505*265*280	1735*310*315

# Product Gallery

